

J. S. BENSON

WOODWORKING & DESIGN, LLC

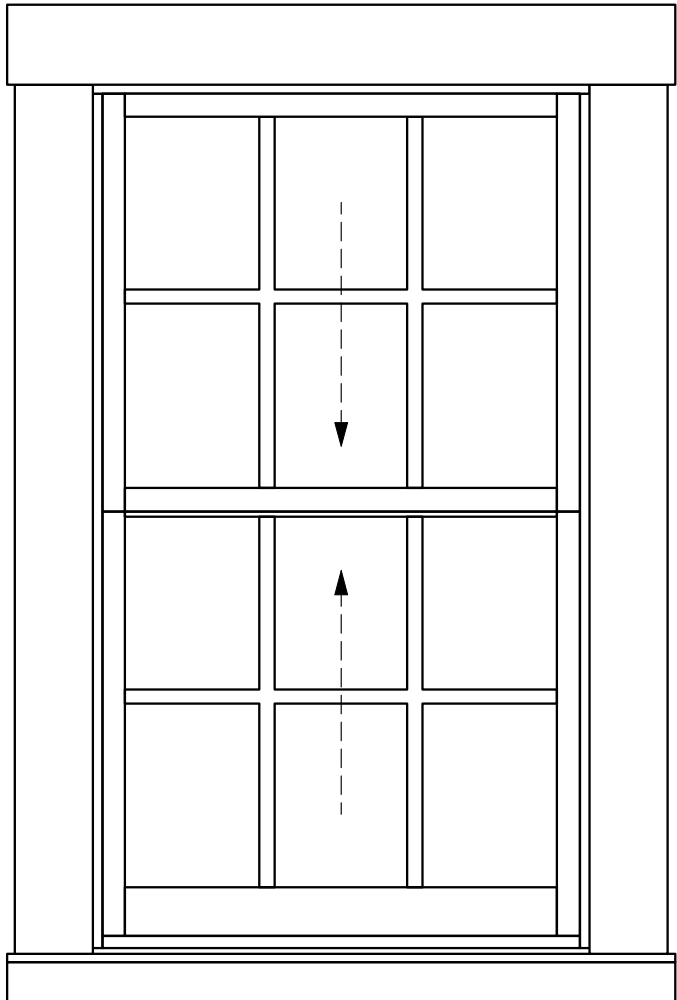

DOUBLE-HUNG WINDOWS

CONFIGURATIONS AVAILABLE:

Straight-cut, Arch-top, Round-top, Gothic-top,
Bowed in plan with straight or curved glass,
Single-hung, Double-hung, and Triple-hung.

STANDARDS:

- 1) 1-3/4" Thick mahogany sash allow plenty of room for most weather-stripping, glazing, balancing, and interior stop options.
- 2) 1" Wide true divided light muntins with our faux-putty exterior profile.
- 3) Mahogany 5/4" jambs, 8/4" mahogany sills.
- 4) Swiss silicone rubber gaskets and copper side tracks.
- 5) Hydrochrom urethane high performance paint.
- 6) Solid brass sash locks.

OPTIONS:

- 1) True divided light (TDL) muntins as narrow as 7/8" with insulating glass.
- 2) Sash from 1-3/8" to 2-11/16" thick with insulating glass.
- 3) Balance options: Weight & pulley, Invisible spring block & tackle, etc.
- 4) Bronze, fiberglass, aluminum, or stainless steel screens in mahogany frames.
- 5) Brass, Copper or Aluminum exterior cladding.
- 6) Insulated glass: Warm-edge spacers in a variety of colors.
Low-E, Argon fill, storm resistant laminated glass, tempered,
Restoration glass over Low-E, Art glass, Acoustic glazing.
- 7) Custom Casings, Sill-noses, Muntins, and other accessories.

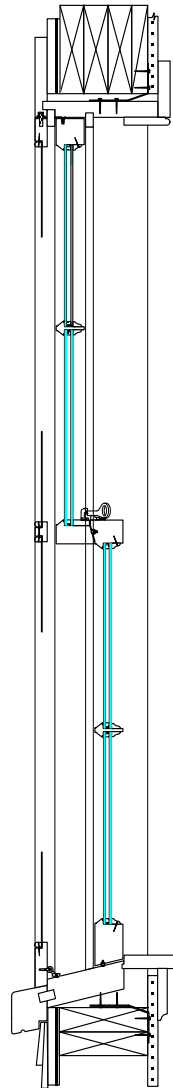

1741 Route 7 South
Middlebury, Vermont 05753
1-800-339-3515
E-mail: jsbwood@sover.net
Web: jsbensonwoodworking.com